

Tesoura 1 (x7)

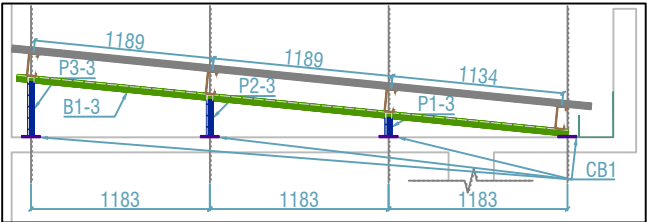

Tesouras 3 (x2)

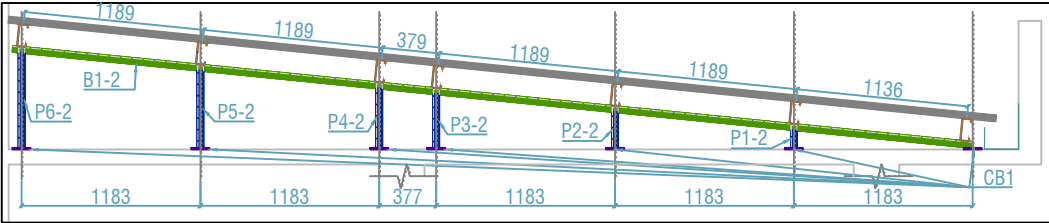

Tesoura 2 (x6)

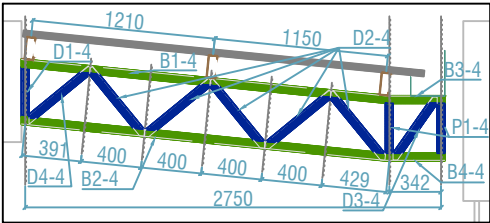

Tesouras 4 (x4)

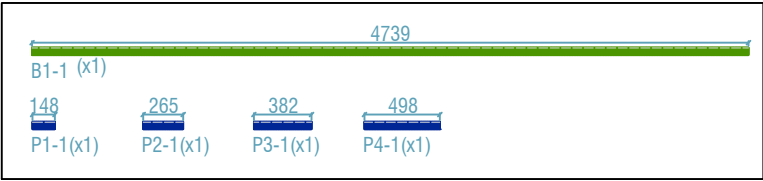

Peças Tesoura 1 (x7)

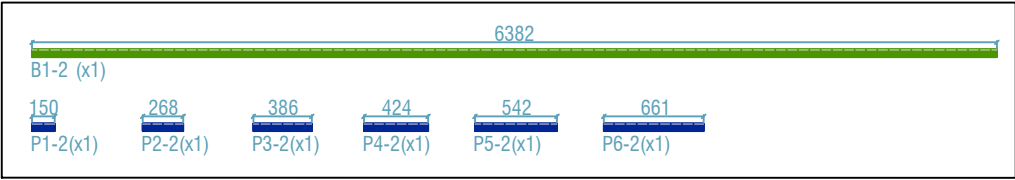

Peças Tesoura 2 (x6)

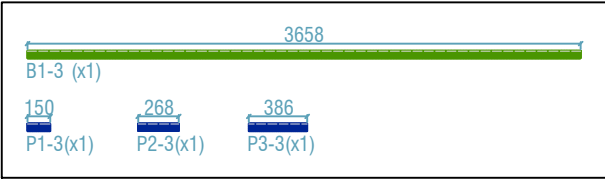

Peças Tesoura 3 (x2)

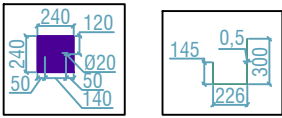

CB1 (x85) Calhas

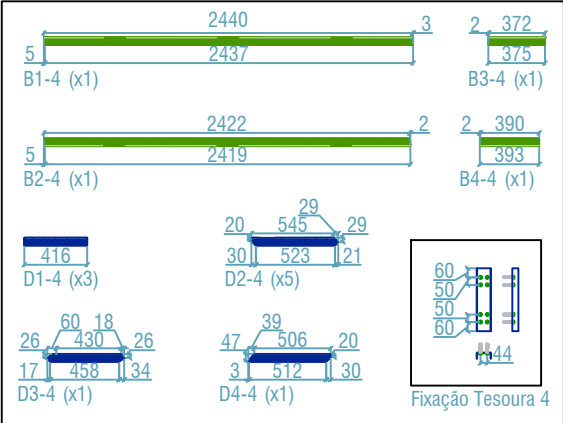

Peças Tesoura 4 (x4)

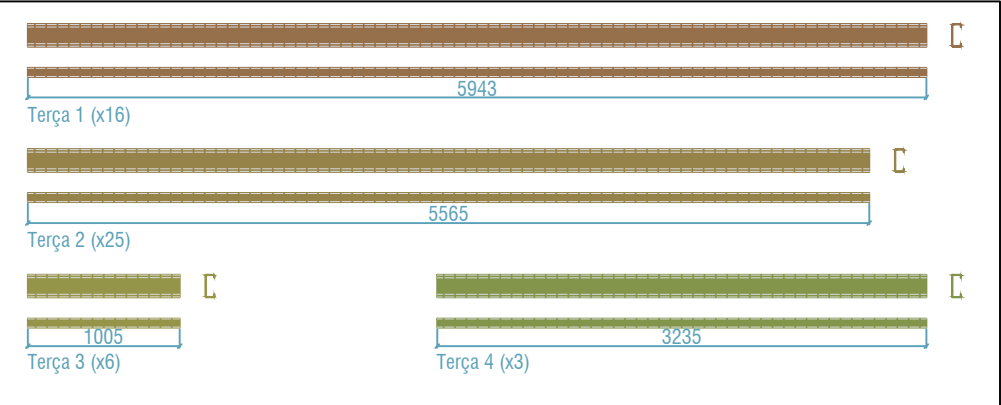

Terças

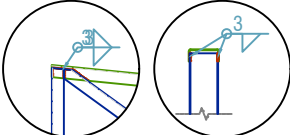

Soldas das tesouras

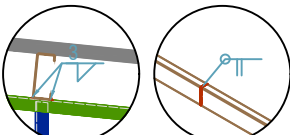

Soldas das terças

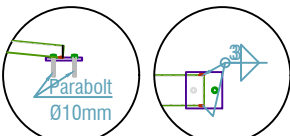
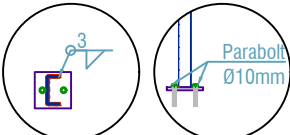

Soldas dos pontaletes

Telhados Secundários										
Peça	Perfil	Quantidade	Comprimento (mm)	Altura (mm)	Largura (mm)	Espessura (mm)	Massa Unitária (Kg)	Massa Total (Kg)	Área de Pintura (m²)	Área de Pintura Total (m²)
B1-1	U 150 x 50 # 2.65	7	4739	150	50	2.65	4.99	34.93	1.16	8.12
B1-2	U 150 x 50 # 2.65	6	6382	150	50	2.65	4.99	29.94	1.56	9.38
B1-3	U 150 x 50 # 2.65	2	3658	150	50	2.65	4.99	9.98	0.90	1.79
B1-4	U 150 x 50 # 2.65	4	2440	150	50	2.65	4.99	19.96	0.60	2.39
B2-4	U 150 x 50 # 2.65	4	2422	150	50	2.65	4.99	19.96	0.59	2.37
B3-4	U 150 x 50 # 2.65	4	375	150	50	2.65	4.99	19.96	0.09	0.37
B4-4	U 150 x 50 # 2.65	4	393	150	50	2.65	4.99	19.96	0.10	0.39
P1-1	U 150 x 50 # 2.65	7	148	150	50	2.65	4.99	34.93	0.04	0.25
P2-1	U 150 x 50 # 2.65	7	265	150	50	2.65	4.99	34.93	0.06	0.45
P3-1	U 150 x 50 # 2.65	7	382	150	50	2.65	4.99	34.93	0.09	0.65
P4-1	U 150 x 50 # 2.65	7	498	150	50	2.65	4.99	34.93	0.12	0.85
P1-2	U 150 x 50 # 2.65	6	150	150	50	2.65	4.99	29.94	0.04	0.22
P2-2	U 150 x 50 # 2.65	6	268	150	50	2.65	4.99	29.94	0.07	0.39
P3-2	U 150 x 50 # 2.65	6	386	150	50	2.65	4.99	29.94	0.09	0.57
P4-2	U 150 x 50 # 2.65	6	424	150	50	2.65	4.99	29.94	0.10	0.62
P5-2	U 150 x 50 # 2.65	6	542	150	50	2.65	4.99	29.94	0.13	0.80
P6-2	U 150 x 50 # 2.65	6	661	150	50	2.65	4.99	29.94	0.16	0.97
P1-3	U 150 x 50 # 2.65	2	150	150	50	2.65	4.99	9.98	0.04	0.07
P2-3	U 150 x 50 # 2.65	2	268	150	50	2.65	4.99	9.98	0.07	0.13
P3-3	U 150 x 50 # 2.65	2	386	150	50	2.65	4.99	9.98	0.09	0.19
D1-4	U 150 x 50 # 2.65	12	416	150	50	2.65	4.99	59.88	0.10	1.22
D2-4	U 150 x 50 # 2.65	20	574	150	50	2.65	4.99	99.80	0.14	2.81
D3-4	U 150 x 50 # 2.65	4	509	150	50	2.65	4.99	19.96	0.12	0.50
D4-4	U 150 x 50 # 2.65	4	545	150	50	2.65	4.99	19.96	0.13	0.53
-	Resumo U 150 x 50 # 2.65							703.59		36.06
Terça 1	UE 150 x 60 x 20 # 2.65	16	5943	150	60	2.65	6.02	96.32	1.75	28.03
Terça 2	UE 150 x 60 x 20 # 2.65	25	5565	150	60	2.65	6.02	150.50	1.64	41.00
Terça 3	UE 150 x 60 x 20 # 2.65	6	1005	150	60	2.65	6.02	36.12	0.30	1.78
Terça 4	UE 150 x 60 x 20 # 2.65	3	3235	150	60	2.65	6.02	18.06	0.95	2.86
-	Resumo U 150 x 50 # 2.65							301.00		73.67
-	Resumo Perfis							1004.59		109.73
Peça	Chapa	Quantidade	Comprimento (mm)	Largura (mm)	Espessura (mm)	Área (cm²)	Massa Unitária (Kg)	Massa Total (Kg)	Área de Pintura (m²)	Área de Pintura Total (m²)
CB1	Chapa 240x240 #10mm	85	240	240	10	576.00	4.52	384.34	0.12	9.79
-	Resumo Chapas #10mm							384.34		9.79
-	Resumo A36 - MR250							1388.93		119.52
Calhas										
Item	Nome		Comprimento (mm)		Espessura (mm)		Perímetro Lateral (mm)		Peso (kg)	
Calha 1	Calha 178.29cm		17829		0.5		671.00		46.96	
Calha 2	Calha 225.4cm		22540		0.5		671.00		59.36	
Calha 3	Calha 88.8cm		8880		0.5		671.00		23.39	
-	Resumo Calhas								129.71	
Parafusos, chumbadores e arruelas										
Item	Parafusos		Diâmetro Nominal (mm)		Comprimento (mm)		Quantidade		Observações	
Chumbador	Chumbadores		9.525		127		234.00		Chumbadores 3/8x5"	